

ECOFLO TOWER

HEPA Filtered Supply Blower for Ventilated Rodent Racks



Features:

- Automatic Filter Load Compensation (FLC™)
- Touch screen display or WiVarium Control
- Differential pressure readings
- Recyclable aluminum materials
- Uses EC motors for lowest power consumption
- HEPA filtration (99.995%)
- 115 and 230 voltage
- Bluetooth™ or WiFi Communication
- WiVarium Plus / Wi-Com Vantage Compatible
- Temperature/Humidity sensor
- Hose clamp and hose included
- Tilted face for easier user viewing
- Dual units (Metric/English)



Specifications:

Voltage	115 or 230Vac, 50/60 Hz, 1Ph
Power	7-23 Watts
Current	0.15A @ 115Vac
Heat Load	20W (70 BTU/hr)
Noise (1m)	42 dBA
Air Quality	Class 5 (ISO 146441)
Filter Class	J or H14
Weight	106 lbs (48 kgs)
Input PWR	IEC-320-C14
Output PWR	IEC-320-C13 (Exh. Blwr)
Alarm/Analog Out	Power, Blower / CFM
Communications	WiFi or Bluetooth

Outputs:

Alarm/Analog

Connector: 4-position, Woodhead Connectivity / Brad Harrison 4R4F06A27C300

Mating Connector: 404000A10M050 (not included with unit) **Note:** Un-powered state = Failure state

Model	Pins 1(BRN) & 4(BLK)		Pins 2(WH) & 3(BL)	
	Type	Output	Type	Output
01	Power	Contact, NO=Fail	Blower	Contacts, NC=Fail
02	Power	Contact, NC=Fail	Blower	Contacts, NC=Fail
04	Power	Contact, NO=Fail	Blower	Contacts, NO=Fail

ECOFLO TOWER

Miscellaneous:

Cord Set

- NEMA 5-15P to IEC320-C13

Replacement Parts

- Supply Prefilter: PF1273AL Exhaust Prefilter: PF14105AL
- HEPA filter: HF8126

Physical Dimensions:

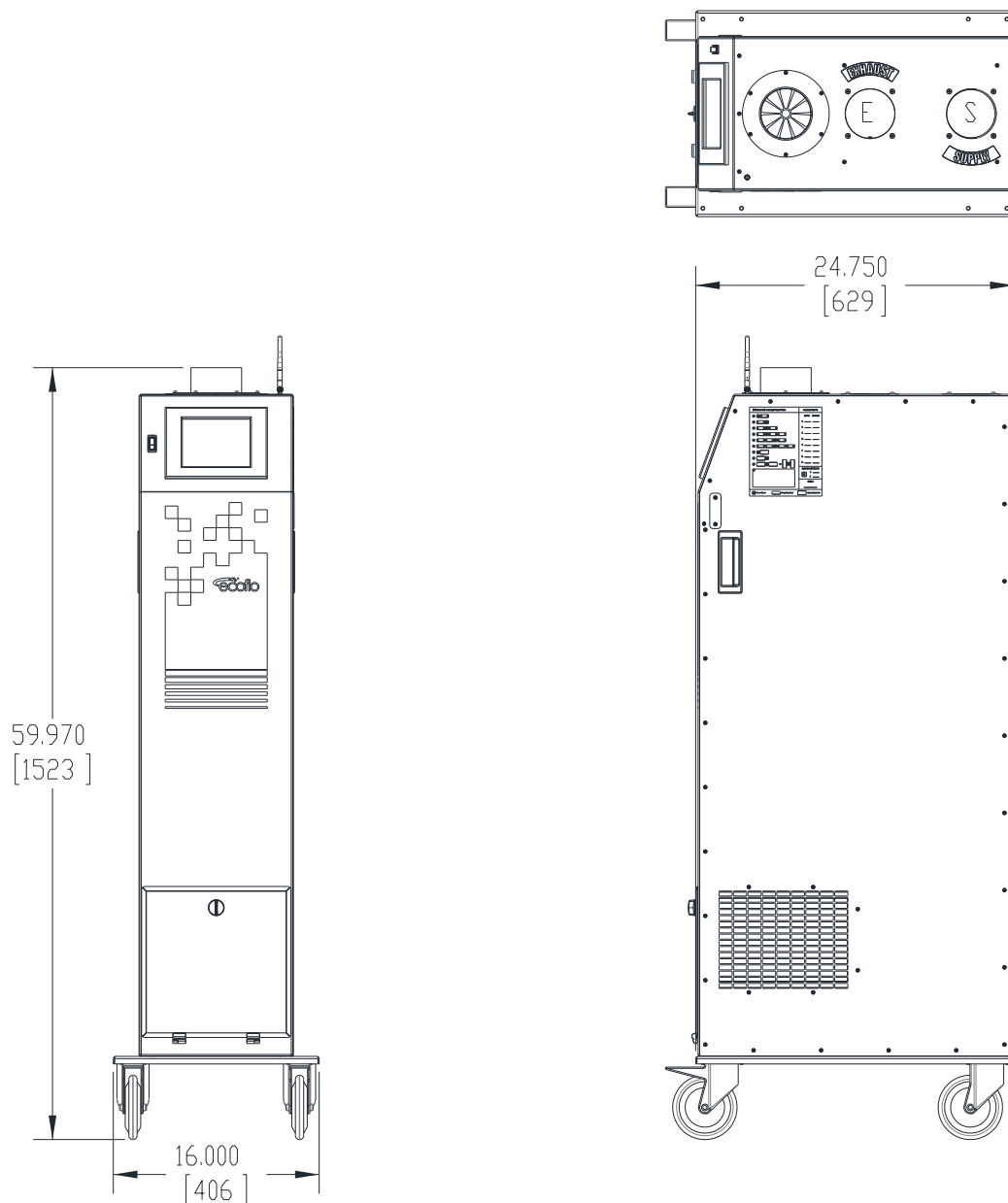

Allentown products are highly customizable at the end users request and this data sheet may not reflect the exact parameters specified for a specific project. Allentown recommends that projects that have critical size, airflow, water or electrical needs be handled through approval drawings to insure all critical areas are addressed and have visibility throughout the team including, A&E, MEP and construction persons.